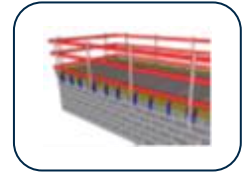

PLAKA CLAMP

Edge protection system

REF 04.20.02 - Version V01 - 26/08/2020

**Introduction**

This document is in accordance with standard EN 13374 with the aim to inform the end user sufficiently and to provide all necessary information about the safety precautions for :

- To inform the user sufficiently about security questions.
- The expected use of the equipment.
- The safety precautions for handling, installation, operation and maintenance of the equipment.
- The rejection and elimination criteria of the material according to the applicable regulations.

We recommend to read the manual carefully before using the safety device, with special attention to the essential points.

Only by adhering to the standards and recommendations in this manual, a safe handling and a good maintenance of the temporary edge protection system can be guaranteed.

This manual is an integral part of the supplied equipment. It is therefore essential not to lose them and to use it during the entire life cycle of the product.

Plaka Clamp is a temporary edge protection system of **class A**.

Class A edge protection systems are designed to withstand only static loads, based on a requirement to:

- Support a person leaning on the protection or provide a handhold when walking beside it, and
- Arrest a person who is walking or falling towards the protection.

Temporary edge protection systems of class A can be used if the slope of the floor is less than 10 degrees.

General information

As required by the current legislation, the manufacturer warrants this product against manufacturing defects and defects in the used materials.

The manufacturer will not be responsible for direct or indirect damage to people or goods, due to improper use of the equipment, or the result of an operation not covered by the manual.

The guarantee is not valid in the following cases:

- The product is damaged or altered.
- The product is used in a wrong way.
- The product is used without taking into account the restrictions in this guideline, or has been exposed to a too high mechanical load.
- Insufficient or incorrect maintenance.
- The product is damaged due to the transport, installation or application.
- The product is used with other accessories than the original ones.

PLAKA CLAMP

Edge protection system

REF 04.20.02 - Version V01 - 26/08/2020

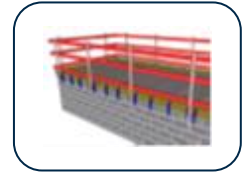

Product identification

Manufacturer's mark : CROC

Tested by CETIM (Test report n° TEC0000981)

Product description

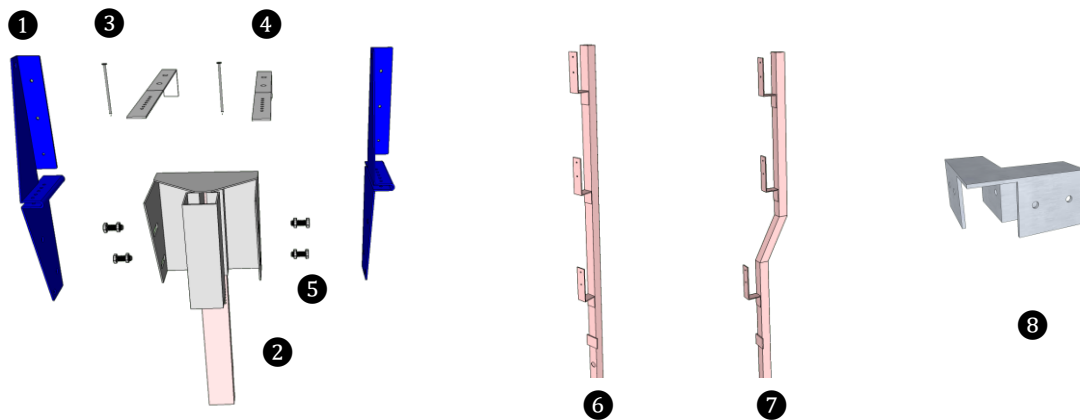

1. Shelf support
2. Console
3. Nail
4. Spacer
5. Bolt
6. Handrail post: straight, square tube, type A
7. Handrail post: folded, square tube , type B
8. Corner piece

Reference of the order:

Standard epoxy shelf support	SEBSABE
Double back support with holder for shelves	SEBSABEDOU
L-shaped alu spacer for pad 14-19-25 cm	SEBENTALU140
Handrail post, straight, type A	SEBPOTEAU
Handrail post, folded, type B	SEBPOTEAUCOUR
Blocking system	SEBGACH
Corner piece	SEBCOIN

©Copyright protected

This sheet, written with great care, supersedes all previous versions. The technical information on the design, models, illustrations, design values and specifications are believed to be accurate. We make no warranties (expressed or implied) as to its accuracy and assumes no liability in connection with non suitable use of this product. We reserve the right to modify the contents of this form without prior notice.

PLAKA CLAMP

Edge protection system

REF 04.20.02 - Version V01 - 26/08/2020

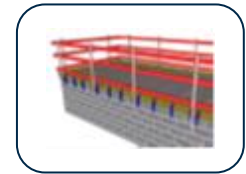

Preceding controls

1. Check if the console of the edge protection system is complete.
 - It consists of the body of the console with 2 shelf supports, both secured by 2 bolts and nuts.
 - Check the tightened bolts.
2. Check the general equipment condition, mainly the weld quality.
3. Any malfunction makes the edge protection system impossible for the use it is intended.

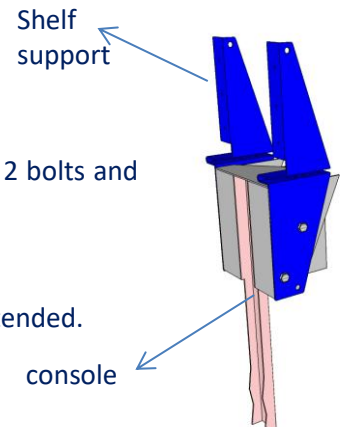

Placement

1. Place the spacers and adjust them according to the wall thickness.
2. Block the spacer in the correct position by a steel nail with a minimum diameter of 2mm (max. 3mm) in the opening provided for this purpose.
3. Place the whole on top of the bearing exterior wall with a maximum intermediate distance of 2,4m (wooden shelves with resistance C24, class A must have a minimum diameter of 32/100mm).

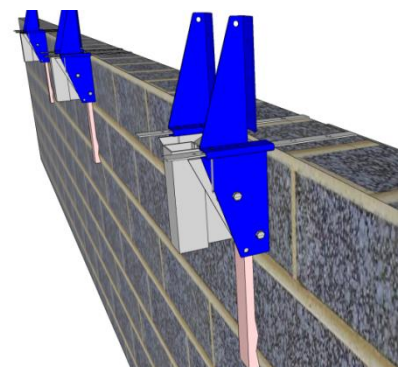
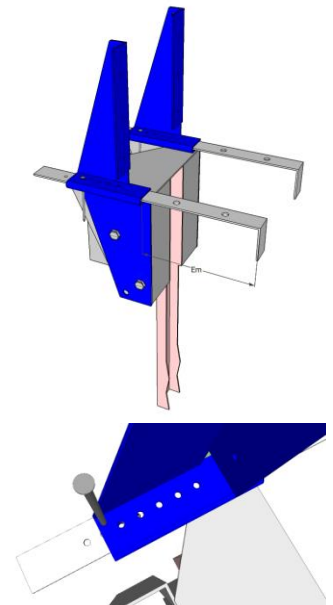

PLAKA CLAMP

Edge protection system

REF 04.20.02 - Version V01 - 26/08/2020

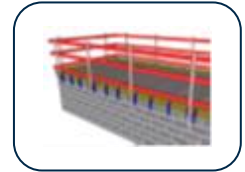

In case of placement on the wall parallel to the laying direction of the core slabs, or in case of an in-situ floor, the spacer should be screwed in the upper part of the bearing wall into the therefore provided hole.



4. It is possible to place a third spacer somewhat below the other spacers to avoid the system turning over. Slots provided.

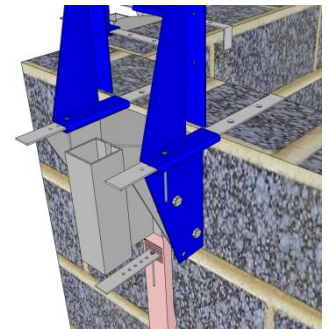

For a protection class A, with wooden shelves with a resistance C24, the maximum scope (IOW the maximum distance between two handrail posts) is determined by the dimensions of the shelves, as shown in the table below.

Thickness in mm Width in mm	16	19	22	25	32	38	62
75		1.2 m					
100		1.4 m	1.6 m	1.8 m	2.4 m		
115	1.2m	1.4 m		1.9 m	2.5 m	2.9 m	
125	1.3 m	1.5 m	1.7 m	2.0 m	2.6 m	3.0 m	4.8 m
150	1.3 m	1.6 m	1.8 m	2.1 m	2.7 m	3.2 m	5.2 m
175	1.4 m	1.7 m		2.2 m	2.8 m	3.4 m	
200	1.5 m	1.8 m		2.3 m	3.0 m	3.5 m	
225		1.8 m		2.4 m	3.1 m	3.7 m	

PLAKA CLAMP

Edge protection system

REF 04.20.02 - Version V01 - 26/08/2020

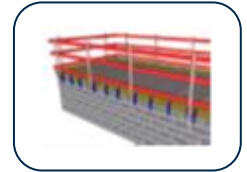

The edge protection system needs to be placed from a scaffold (for example: to build the wall) that complies with applicable legislation. For your own safety it is not allowed to place the edge protection system from a ladder. The distance to the edge shall be equal to or smaller than 50cm.

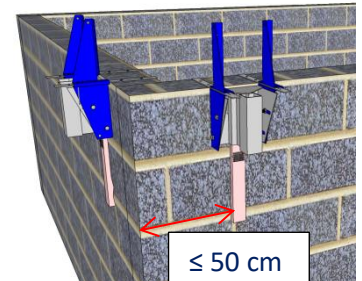

- 4.1 If the system is also used as edge formwork system, then you need to place the shelf supports before the formwork. It is recommended to place them every 60 to 80 cm in function of the resistance of the used formwork.

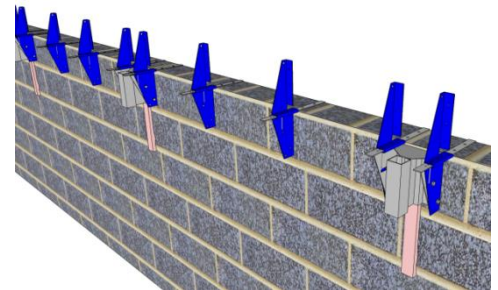

- 4.2 Then place the shuttering panels.

The shelf supports are designed for shuttering panels with thickness 15 to 27mm.

The shuttering panel can be placed later, in function of the organization of the activities on the site .

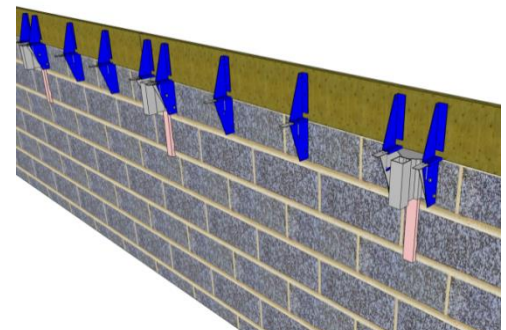

5. Place the floor slabs / prefabricated concrete slabs / shuttering panels and place the handrail posts (straight posts) of the edge protection system with the help of adapted individual protection systems.

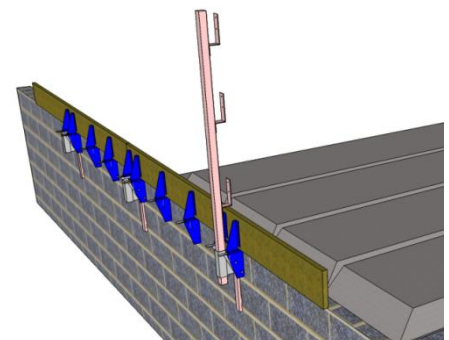

PLAKA CLAMP

Edge protection system

REF 04.20.02 - Version V01 - 26/08/2020

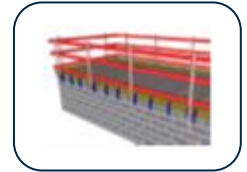

The handrail posts of the edge protection system should be pushed in as far as they can.

An optional blockage system against suddenly tipping over of the handrail posts is possible. The posts of the edge protection system are automatically provided with a hole for this blocking system. The blocking system makes it possible to remove the posts from above without any intervention at the level of the consoles.



First softly lift up the post (there is some slack), then lower it again to pull out hard and quickly. The blockage dislodges and the handrail post can then be easily removed.

It is also possible to use a folded handrail post. In this case, the bricklayers will not be disturbed by the wooden shelves during their work.

The post should be positioned in such a way the wooden shelves are always placed at the side of the workfloor.



not be disturbed by

placed at the side of

- Place the shuttering panels and the wooden shelves.

The bottom must have a height of at least 15 cm.

Make sure the wooden shelves pass the posts at least 25 cm in the overlap with adjoining bars.

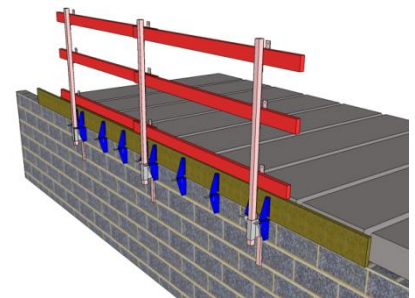

- Screw or nail the wooden shelves on the posts through the appropriate holes in the posts.

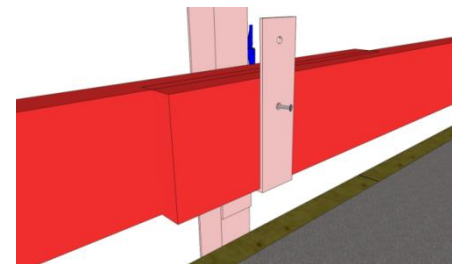

In the corners the shelves are linked together using the provided corner piece. This piece must be attached by at least 1 nail in each shelf.

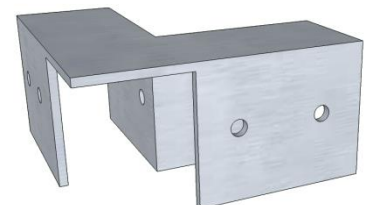

PLAKA CLAMP

Edge protection system

REF 04.20.02 - Version V01 - 26/08/2020

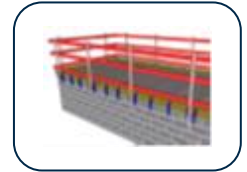

8. Pour the concrete floor in complete safety.

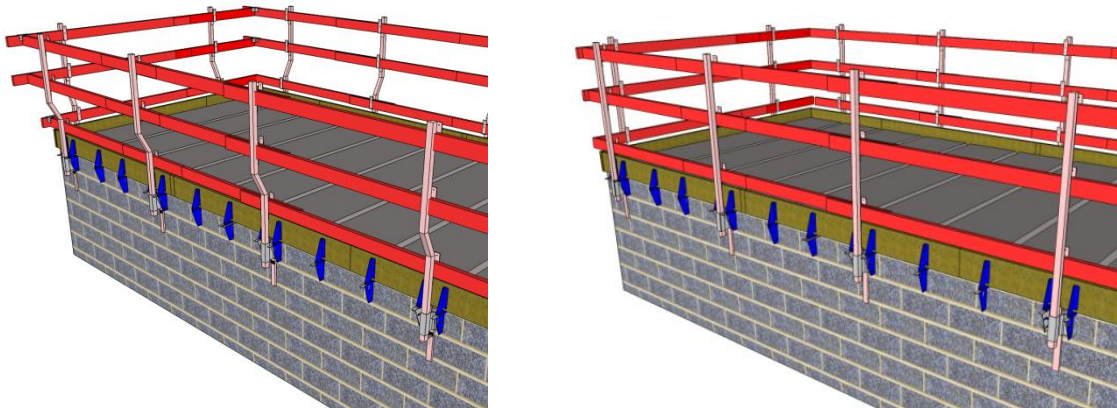

Disassembly

The disassembly can be done as soon as the protection system is no longer necessary.

It begins with the removal of the wooden shelves, then the posts and finally the nails, after then it is possible to remove the shelf support.

The spacer must be decomposed until the edge of the bearing wall.

This one is provided with a few cuts according to the different thicknesses of a bearing wall (14-19-25cm).

After some bending and folds back, the spacer will break at the height of this slice.

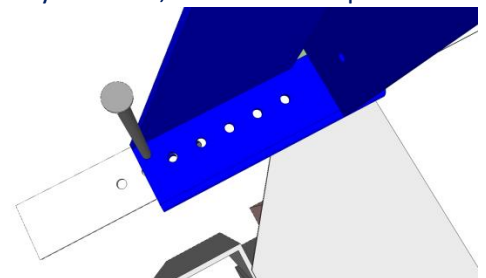

The disassembly takes place during the application of the outer covering, when the scaffold is already placed. If there is no scaffold present, an elevated platform needs to be used. For your own safety, the disassembly can not be done by using a ladder.

Maintenance

The material should be checked before each use by an authorized person. An audit checklist must be completed and provided with the inspection date and signature (preview available, attached and on the website www.constructiv.be).

The welds must be continuous and must show no rust stains.

In case a person falls against the protection system, the material needs to be checked and removed and/or replaced if necessary.

©Copyright protected

This sheet, written with great care, supersedes all previous versions. The technical information on the design, models, illustrations, design values and specifications are believed to be accurate. We make no warranties (expressed or implied) as to its accuracy and assumes no liability in connection with non suitable use of this product. We reserve the right to modify the contents of this form without prior notice.

PLAKA CLAMP**Edge protection system**

REF 04.20.02 - Version V01 - 26/08/2020

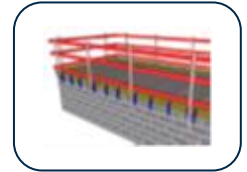
**Checklist**

- ✓ Check the condition of the equipment.
- ✓ Check that all the posts are pushed in.
- ✓ Check that all the nails are present.
- ✓ Check to make sure the spacers on which no plates/construction slabs will be placed, are firmly attached.
- ✓ Check to make sure there is no gap between the shelf and the wall.
- ✓ Check to make sure there is no gap between the shelf and the console.
- ✓ Check the presence of the corner pieces on the wooden shelves.
- ✓ Check the connection between the wooden shelves and the posts.

Bibliography

- Standard NF EN 13374 Oktober 2004
- Royal Decree of 30 August 2013 laying down general provisions on the choice, purchase, the use of collective protections (Belgian Official Gazette 7.10.2013)
- Royal Decree of 31 August 2005, concerning the use of work equipment provided for temporary work at a height. (Belgian Official Gazette 15.9.2005; errata: Belgian Official Gazette 22.8.2006)
- Prevention sheet "Use of temporary edge protection systems" CBM001 – v02 17/12/2014 –NAVb-CNAC constructiv
- Checklist (Dutch) :
http://navb.constructiv.be/nl/Campagnes_en_acties/Veilig_werken_op_hoogte/Tools/Checklists.aspx
- Checklist (French) :
http://cnac.constructiv.be/fr/Campagnes_et_actions/Travailler_en_hauteur_en_toute_securite/Tools/Checklists.aspx